

Foamate™ HP

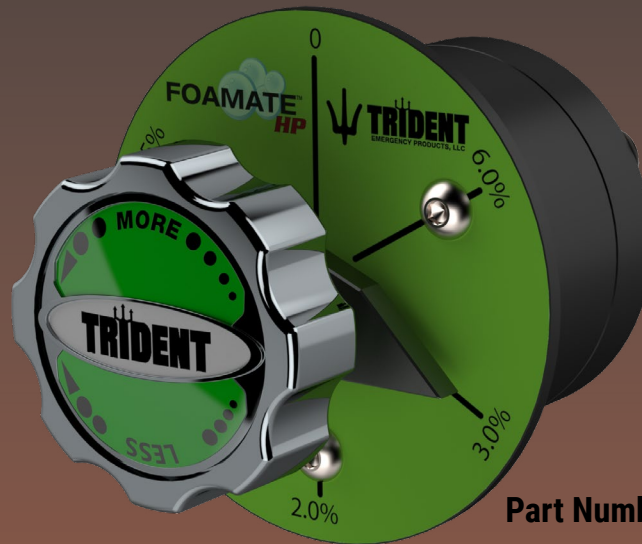

Part Number - #31.032.0

PRODUCT DESCRIPTION

The Trident Foamate™ HP is a class A foam proportioner designed for ultra high-pressure firefighting systems. Conforming to NFPA accuracy standards, the complete metering valve and eductor assembly guarantee accurate foam injection rates. Simple operation – selectable foam percentage while maintaining water flow.

PRODUCT FEATURES

- Through-The-Pump Foam Proportioner
- Compatible with Class A Foam Concentrates
- Compatible with Ultra High Pressure Firefighting Systems
- Flush in 0% (OFF) Position
- Factory Calibrated for 20 GPM Water Flow
- Conforms to NFPA Standards
- Mil-Spec Hard Coat Aluminum & Stainless-Steel Construction
- Panel or Bracket Mounting

FOAM PERFORMANCE NUMBERS

At 20 GPM Water Flow [76 LPM]

0% (OFF/FLUSH), 0.5%, 1.0%, 2.0%, 3.0%, 6.0%

PLUMBING SCHEMATIC

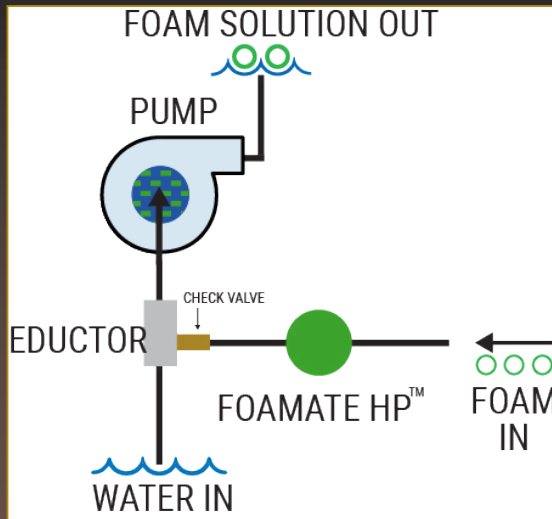

PANEL CUT-OUT DIMENSIONS

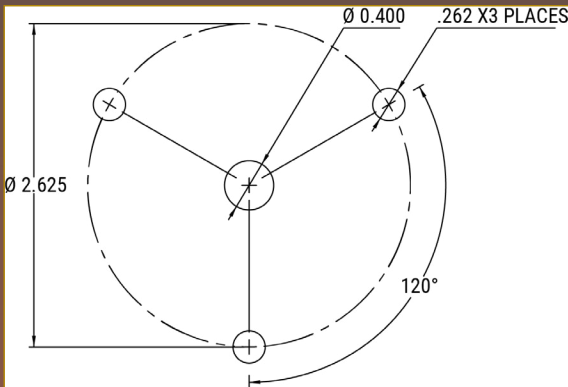

EDUCTOR ASSEMBLY DIMENSIONS

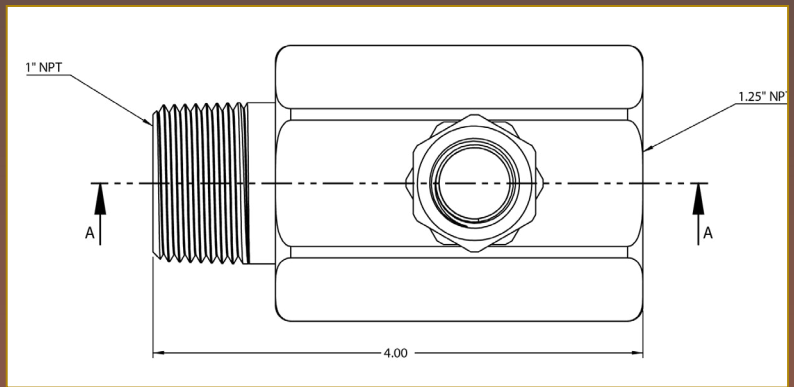

EDUCTOR ASSEMBLY

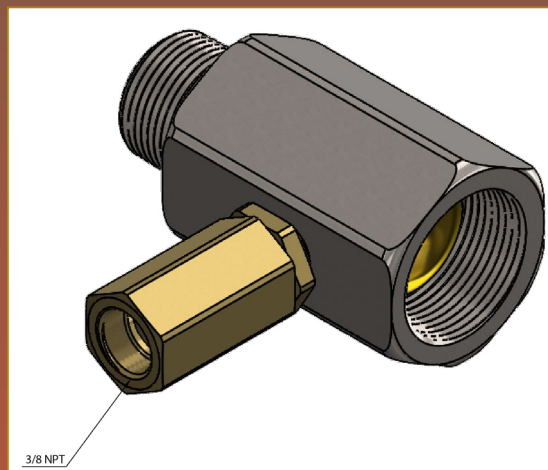

TRIDENT EMERGENCY PRODUCTS, LLC

World Class Fire Industry Products

2950 Turnpike Drive, Unit #21
Hatboro, PA 19040

Contact us for Support

Phone 215-593-0700 | Fax 215-293-0701

Email sales@tridentdirect.com



WWW.TRIDENTDIRECT.COM