

TRIDENT

AIR MAX™

REVOLUTIONARY...

This New **Suction Side Relief Valve** uses an Easily Adjustable Air Spring to allow Maximum Water Flow.

Designed for “**MAX**” Protection to Personnel and Equipment.

A simple air regulator is used to adjust the cracking pressure for this Innovative Suction Side Relief Valve. The “Air Spring” will allow the relief valve to open fully regardless of the set cracking pressure for more precise operation. Ordinary mechanical spring relief valves produce an increasing force as they are forced open and compromise the desired set pressure rating.

The Full Opening Design of the AirMax allows for Maximum Flow of Water Through The Valve.

More Water Flow means More Pressure Protection for Personnel and Equipment.

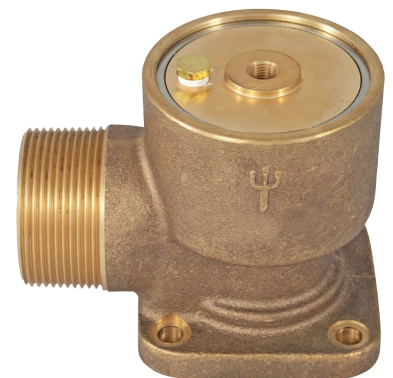

AirMax Features:

- ▶ Flows up to 750 GPM
- ▶ Set from 50 to 300 PSIG
- ▶ Remote Control Adjustment
- ▶ Exceeds NFPA 1901 Standard
- ▶ 2½" MNPT Outlet or...
- ▶ 2½" Victaulic Outlet
- ▶ Four (4) Bolt Mounting Flange
- ▶ Self Draining
- ▶ Air Powered Operation
- ▶ All Brass and Stainless Steel Construction
- ▶ Corrosion Resistant
- ▶ Air Regulator Included
- ▶ One Regulator Controls Many Relief Valves On Truck



Brass Relief Valve Body is available as either a 2½" MNPT or 2½" Victaulic with Four (4) Bolt Mounting Flange.

AIR MAX™

Trident Emergency Products, LLC

2940 Turnpike Drive | Suite #9 | Hatboro, Pennsylvania 19040
215-293-0700 Phone
215-293-0701 Fax
sales@tridentdirect.com Email

www.tridentdirect.com

Page 1 of 2



World Class
Fire Apparatus
Plumbing and
Hardware Products

AirMax™ is a trademark of
Trident Emergency Products, LLC

Installer Notes (Pump Panel Mount)

- Using the dimensions shown in Figure 1, prepare the panel opening.
- Mount the placard, regulator and gauge. Ensure that the small hole behind the turn knob is facing down.
- Mount the AirMax valve on the pump and connect the 2½" pipe or Victaulic connection. Use Loctite 242 or equal.
- Use pipe dope paste only in all regulator ports.
- Regulator ports are ¼" FNPT threads.
- All airlines must be rated for air brake usage.
- Avoid sharp edges, high heat and kinks when installing airlines.
- Connect the airline from the regulator to the gauge.
- Connect the airline from the regulator to the AirMax valve.
- Plug all unused ports.
- In cold weather areas it is advisable that the discharge water be plumbed away from the pump operators position.

Operator Notes (Pump Panel Mount)

The AirMax relief valve functions through air obtained from the air brake system. When the valve opens (See Figure 2) the excess water is discharged to the ground

To adjust:

- Pull out control knob to unlock.
- Turn knob counter clockwise (left) to lower pressure below what your goal pressure is.
- Next, turn knob clockwise (right) until the gauge reads the desired Set Pressure.
- Finally, depress the knob to lock in the desired setting.



Rear Side of Regulator

Use pipe dope paste on these connections. All unused ports must be plugged.

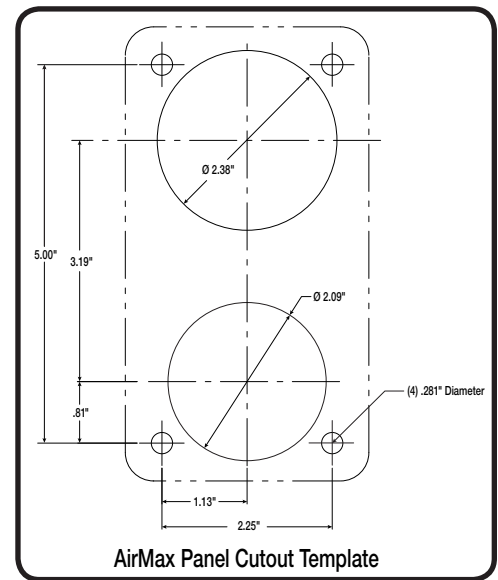

AirMax Panel Cutout Template

Figure 1

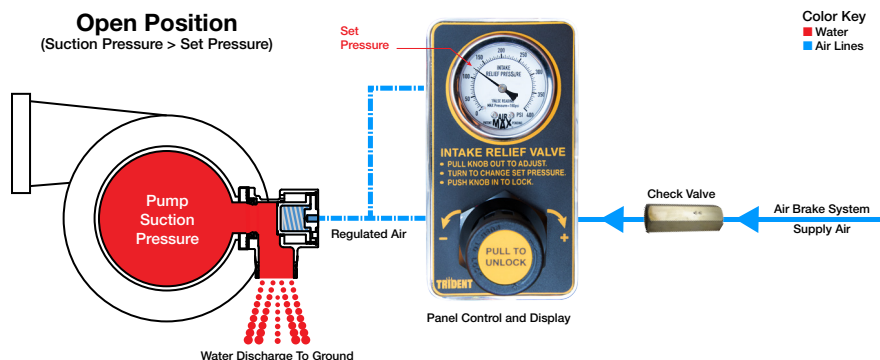
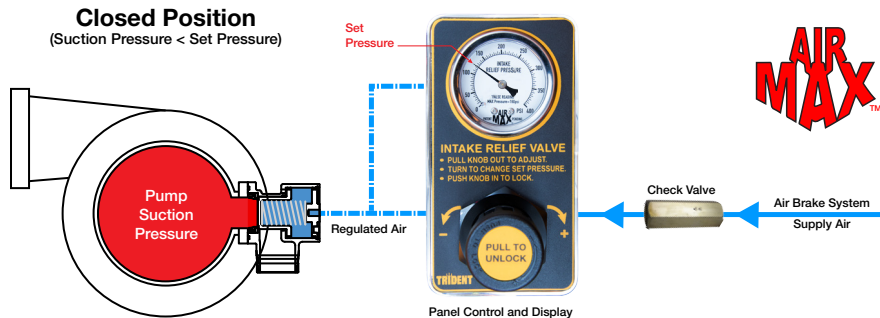

Figure 2